

# ACCESSORIES & MODIFICATIONS

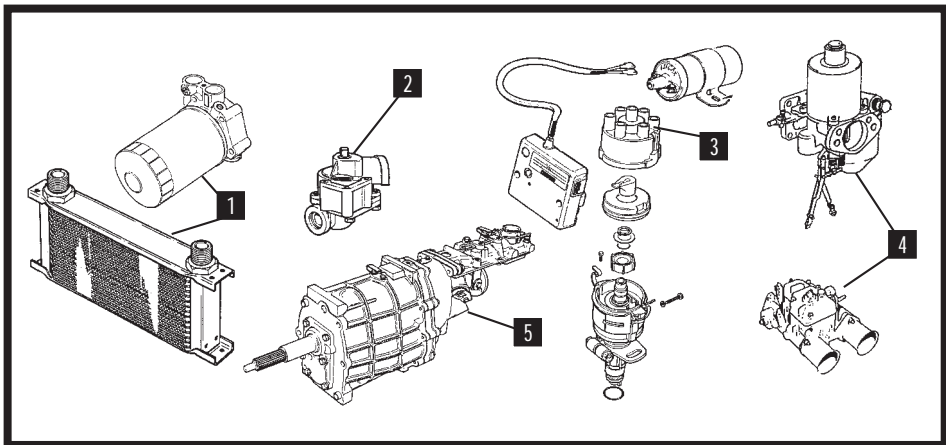

**ENGINE**

UPRATED & COMPETITION ENGINES, CLUTCHES AND CAMSHAFTS ARE AVAILABLE TO SPECIAL ORDER. FULL REQUIREMENTS AND SPECIFICATIONS ARE AVAILABLE ON REQUEST.

WE ARE ALSO ABLE TO OFFER A FULL MACHINING SERVICE, BALANCING OF CRANKSHAFT ASSEMBLIES AND LEAD FREE CONVERSIONS.

**ELECTRONIC IGNITION** Item 3

MODEL	PART No	QTY PER VEHICLE
ALL 6 CYL CARS UPTO SER III XJ6	EIK1	1 KIT

NOTE:- Distributor re-calibrated to individual requirements.

**OIL COOLERS** Item 1

MODEL	PART No	QTY PER VEHICLE
ALL XK MODELS & 6 CYL 'E' TYPE	OCK1	1 KIT
ALL V12 MODELS	OCK2	1 KIT

Except V12 'E' Type.  
Please state exact model as some variations do occur.

**CARBURETTOR CONVERSIONS** Item 4

MODEL	PART No	QTY PER VEHICLE
XK 120/140	H8s	1 PAIR
6 CYL 'E' TYPE FROM STROMBERG TO 3 X SU	FZX3060	1 KIT
6 CYL 'E' TYPE FROM SU TO WEBER	WCC1	1 KIT
OTHER 6 CYL MODELS FROM SU ETC TO WEBER	WCC2	1 KIT
ALL V12 CARB MODELS	WCC3	1 KIT

NOTE:- Please state exact requirements as variations occur on Inlet Manifolds & Linkages. A full compliment of Air Filters & Ram Pipes is also available to suit all models.

**HIGH CAPACITY OIL PUMP** Item 2

MODEL	PART No	QTY PER VEHICLE
LATE XK140-150 & 6CYL 'E' TYPE	C21765/2U	1

**GETRAG GEARBOX CONVERSIONS** Item 5

A CONVERSION KIT IS AVAILABLE TO CHANGE MOST MODELS TO A 5-SPEED MANUAL GEARBOX. THIS IS A UNIVERSAL KIT TO SUIT ALL MODELS AND IT MUST BE STRESSED THAT MODIFICATION TO UNDERBODY PANELS & CLUTCH CONTROLS ETC MAY BE REQUIRED.

**OIL PICK UP PIPES 7/8" BORE** Not Illustrated

MODEL	PART No	QTY PER VEHICLE
LATE XK140-150	C12939U	1
6 CYL 'E' TYPE	C21760U	1

**CRANKSHAFT OIL SEAL CONVERSIONS** Not Illustrated

MODEL	PART No	QTY PER VEHICLE
ALL 6 CYL CARS REAR SEAL	OSC1	1 KIT
XK120 FRONT SEAL	OSC2	1 KIT

Supplied as a kit with crankshaft etc on exchange only!

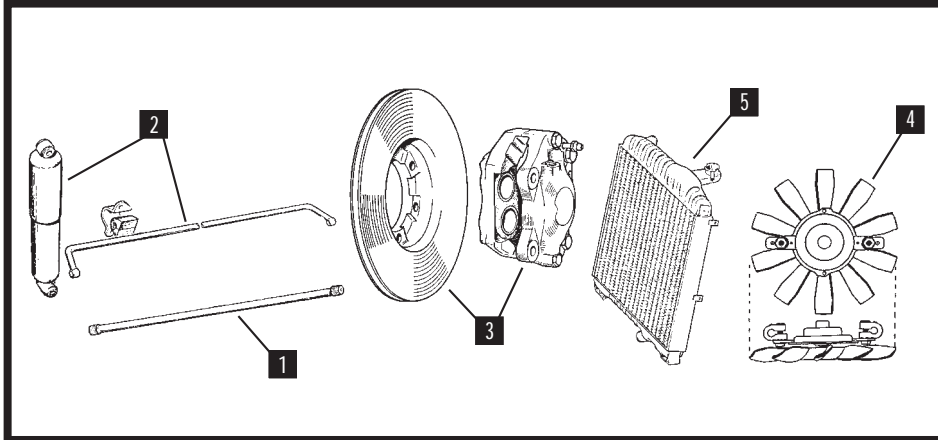

UPRATED TORSION BARS		Item 1
MODEL	PART No	QTY PER VEHICLE
ALL XK MODELS	C5719U	1PR
'6' CYL 'E' TYPE NOT 2+2	C9331U	1PR
V12 'E' TYPE	C34732U	1PR

SOLID WISHBONE BUSHING		Not Illustrated
MODEL	PART No	QTY PER VEHICLE
XK 120-140-150	SWB1	1 KIT
6 CYL 'E' TYPE	SWB2	1 KIT
XJ6-XJS & ALL 12 CYL	SWB3	1 KIT

HANDLING KITS		Item 2
MODEL	PART No	QTY PER VEHICLE
XK 120	HBHK1	1 KIT
XK 140	HBHK2	1 KIT
XK 150	HBHK3	1 KIT
6 CYL 'E' TYPE	HBHK4	1 KIT
V12 'E' TYPE	HBHK5	1 KIT
XJ6	HBHK6	1 KIT
XJS	HBHK7	1 KIT

All kits are supplied with uprated anti roll bars with fittings and "Koni" Shock Absorbers. Uprated anti-roll bars are available separately. Bilstein Shock Absorbers are available as an alternative to "Koni" on the XJ & XJS models.

SOLID RACK MOUNTING		Not Illustrated
MODEL	PART No	QTY PER VEHICLE
6 CYL 'E' TYPE	SRM1	1PR

WIRE WHEELS 6 1/2 x 15"		Not Illustrated
MODEL	PART No	QTY PER VEHICLE
SER I 'E' TYPE	CWW6	4/5
V12 'E' TYPE	CWW4	4/5
XJ & XJS	CWW7	4/5

NOTE:- CWW7 are "Bolt on" wire wheels. Full conversion kits to splined centre lock wire wheels are available for all models.

UPRATED REAR ROAD SPRINGS		Not Illustrated
MODEL	PART No	QTY PER VEHICLE
6 CYL 'E' TYPE	C18977U	4
V12 'E' TYPE	C32062U	4
XJ & XJS	C29978U	4

\* Please state exact model

FRONT DISC BRAKE CONVERSIONS		Item 3
MODEL	PART No	QTY PER VEHICLE
XK 120-140	BCK2	1 KIT
XK 150	BCK3	1 KIT
SER I 'E' TYPE	BCK1	1 KIT

NOTE:- All conversion kits utilise a 3 piston Girling Caliper with 1/2" thickness brake discs. Development is underway on conversions to "vented" discs. Please telephone for latest update. To complement these conversions we are also able to supply Brake Servo and Master Cylinder conversions to all of the above models.

KENLOWE FAN KITS		Item 4
MODEL	PART No	QTY PER VEHICLE
ALL XK MODELS	XKE47/1	1
SER I 'E' TYPE	XKE47	1

NOTE:- These kits are intended as an additional aid to the conventional cooling fan. A kit is available for a direct replacement for the Ser I 'E' Type but does require "Picture Frame" modifications.

UPRATED RADIATORS		Item 5
MODEL	PART No	QTY PER VEHICLE
XK 120	C3463U	1
XK 140	C9616U	1
XK 150	C12922U	1
3.8 'E' TYPE	C16770U	1
SER I 4.2 'E' TYPE	C24252U	1
SER II 4.2 'E' TYPE	C28274U	1
V12 'E' TYPE MAN	C35629U	1
V12 'E' TYPE AUTO	C35630U	1

NOTE:- The above radiators are fitted with an uprated core to give a 25% increase in efficiency. All radiators are supplied on an exchange basis. Other models are available on request.

**BESPOKE SPECIALS  
ENGINEERED TO  
ORIGINAL MODEL  
SPECIFICATION**

Please call  
**(+ 44) 02476 622288**  
for further details



# ACCESSORIES & MODIFICATIONS

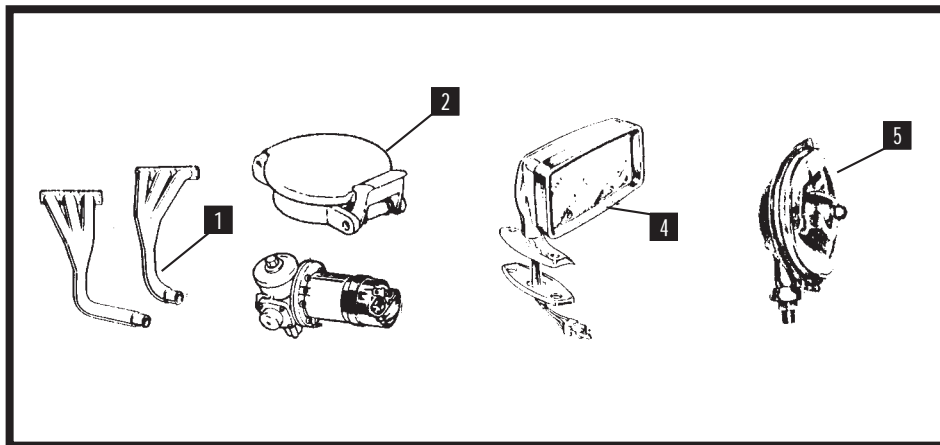

### COMPETITION MANIFOLDS Item 1

MODEL	PART No	QTY PER VEHICLE
XK MODELS	8250/1XKC	1PR.
6 CYL 'E' TYPE	C18396/7C	1PR.

Six Branch exhaust manifolds are supplied as a pair in polished stainless steel. Various types of competition and "straight through" exhaust systems can be supplied for all models in stainless or mild steel. Please telephone with your requirements.

### FOG/SPOT LAMPS Item 5

MODEL	PART No	QTY PER VEHICLE
XK 120	5260XK	2
XK 140/150	5270XK	2
XJ SER 1/2/3 & XJS TO 1987	DAC4316 (Yellow) DAC4315 (Clear)	2 2
XJS 1987 ON	DAC4242 (Yellow) DAC4241 (Clear)	2 2

### MONZA/ASTON FILLER CAPS Item 2

MODEL	PART No	QTY PER VEHICLE
MANY APPLICATIONS	AST35 (Cap) PTO20 (Flange)	1 1

### UPDATED FUEL PUMP Item 3

MODEL	PART No	QTY PER VEHICLE
MOST 6 CYL CARS	AZX1308/COMP	A/R

NOTE:- We also suggest the fitment of a pressure regulator & filter assembly. Tel/fax for full details.

### WING/DOOR MIRRORS Item 4

MODEL	PART No	QTY PER VEHICLE
XK 120-140-150	1250XK RH (Wing)	1
	1251XK LH (Wing)	1
SER I/II 'E' TYPE	XKE76 (Wing)	2
	XKE79 (Door Frame)	2
V12 & 2+2 'E' TYPE	JLM9513 LH (Door)	1
	JLM9512 RH (Door)	1

NOTE:- For XJ range see body fittings.



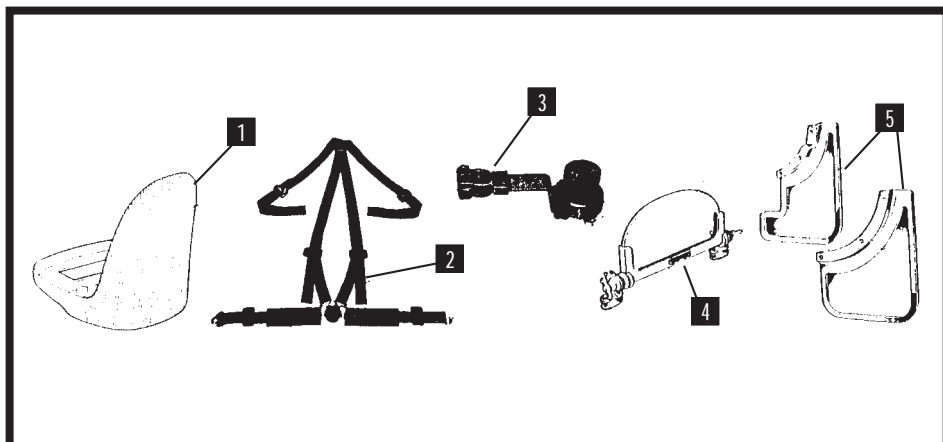

**"BUCKET" SEAT** Item 1

MODEL	PART No	QTY PER VEHICLE
XK 120/140	BD5893C	2
XK 120/140R	BD5893S	2
SER 1 'E' TYPE	BD24175C	2

NOTE:- BD5893S are a shorter version than the original seat to allow for Tonnaeu and Hood to still be used. "One off" seats can be manufactured to customer specification.

**COMPETITION SEAT BELTS** Item 2

ALL MODELS, STYLES & COLOURS CAN BE CATERED FOR. PLEASE TELEPHONE WITH YOUR REQUIREMENTS

**BATTERY CUT OFF SWITCH** Item 3

MODEL	PART No	QTY PER VEHICLE
ALL MODELS	XKE96	1

**BROOKLANDS AERO SCREEN** Item 4

MODEL	PART No	QTY PER VEHICLE
MANY APPLICATIONS	BD4289	A/R

**MUDFLAPS** Item 5

MODEL	PART No	QTY PER VEHICLE
XJ FRONT	JLM9508	1PR.
XJ REAR	JLM345 (Jag) JLM637 (Daimler)	1PR. 1PR.
XJS FRONT	JLM9773	1PR.
XJS REAR	JLM10673	1PR.

NOTE:- Not for use with convertible cars.

**REAR SEAT CONVERSIONS** See Photo

MODEL	PART No	QTY PER VEHICLE
V12 'E' TYPE ROADSTER	RSC1	1
XJS CONVERTIBLE	RSC2	1

